

## BUCHAS DE ESFERAS - STANDARD

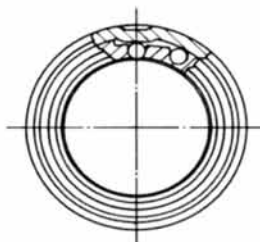

LM ... UU

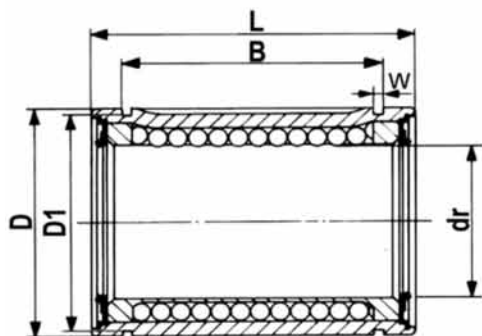
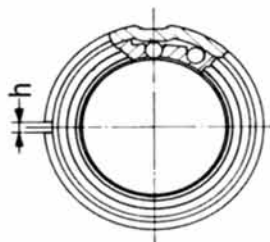

LM ... UUAJ

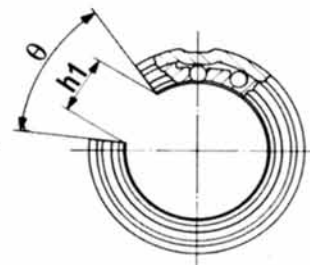

LM ... UUOP

Standard	Circuitos	Massa (g)	Ajustável	Aberto	Ø eixo		D		L		B		W	D1	h	h1	θ	Excentricidade máx. (µm)	Folga Radial máx. (µm)	Capacidade de Carga	
					Tolerância		Tolerância		Tolerância		Tolerância									C (kgf)	Co (kgf)
LM5	4	4	-	-	5	0 -0.008	10	0 0.009	15	0 -0.012	10.2	0 -0.2	1.1	9.6	-	-	-	8	-3	17	21
LM6	4	8	LM 6-AJ	-	6	0 -0.009	12	0 0.011	19	0 -0.2	13.5	0 -0.2	1.1	11.5	1	-	-	12	-5	21	27
LM8	4	16	LM 8-AJ	-	8	0 -0.009	15	0 0.013	24	0 -0.2	17.5	0 -0.2	1.1	14.3	1	-	-	12	-5	27	41
LM10	4	30	LM 10-AJ	-	10	0 -0.009	19	0 0.013	29	0 -0.2	22	0 -0.2	1.3	18	1	-	-	12	-5	38	56
LM12	4	31.5	LM 12-AJ	LM 12-OP	12	0 -0.009	21	0 0.013	30	0 -0.2	23	0 -0.2	1.3	20	1.5	8	80°	12	-5	42	61
LM13	4	43	LM 13-AJ	LM 13-OP	13	0 -0.009	23	0 0.013	32	0 -0.2	23	0 -0.2	1.3	22	1.5	9	80°	12	-7	52	79
LM16	5	69	LM 16-AJ	LM 16-OP	16	0 -0.009	28	0 0.013	37	0 -0.2	26.5	0 -0.2	1.6	27	1.5	11	60°	12	-7	79	120
LM20	5	87	LM 20-AJ	LM 20-OP	20	0 -0.010	32	0 0.016	42	0 -0.2	30.5	0 -0.2	1.6	30.5	1.5	11	60°	15	-9	88	140
LM25	6	220	LM 25-AJ	LM 25-OP	25	0 -0.010	40	0 0.016	59	0 -0.3	41	0 -0.3	1.85	38	2	12	50°	15	-9	100	160
LM30	6	250	LM 30-AJ	LM 30-OP	30	0 -0.010	45	0 0.016	64	0 -0.3	44.5	0 -0.3	1.85	43	2.5	15	50°	15	-9	160	280
LM35	6	390	LM 35-AJ	LM 35-OP	35	0 -0.012	52	0 0.019	70	0 -0.3	49.5	0 -0.3	2.1	49	2.5	17	50°	20	-13	170	320
LM40	6	585	LM 40-AJ	LM 40-OP	40	0 -0.012	60	0 0.019	80	0 -0.3	60.5	0 -0.3	2.1	57	3	20	50°	20	-13	220	410
LM50	6	1580	LM 50-AJ	LM 50-OP	50	0 -0.012	80	0 0.022	100	0 -0.3	74	0 -0.3	2.6	76.5	3	25	50°	20	-13	390	810
LM60	6	2000	LM 60-AJ	LM 60-OP	60	0 -0.015	90	0 0.022	110	0 -0.3	85	0 -0.3	3.15	86.5	3	30	50°	25	-16	480	1020

